

Biggest question for MR: (from last iTOP mechanical mtg)

How will the strongback be fastened to the QBB?

See following slides.

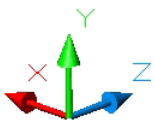
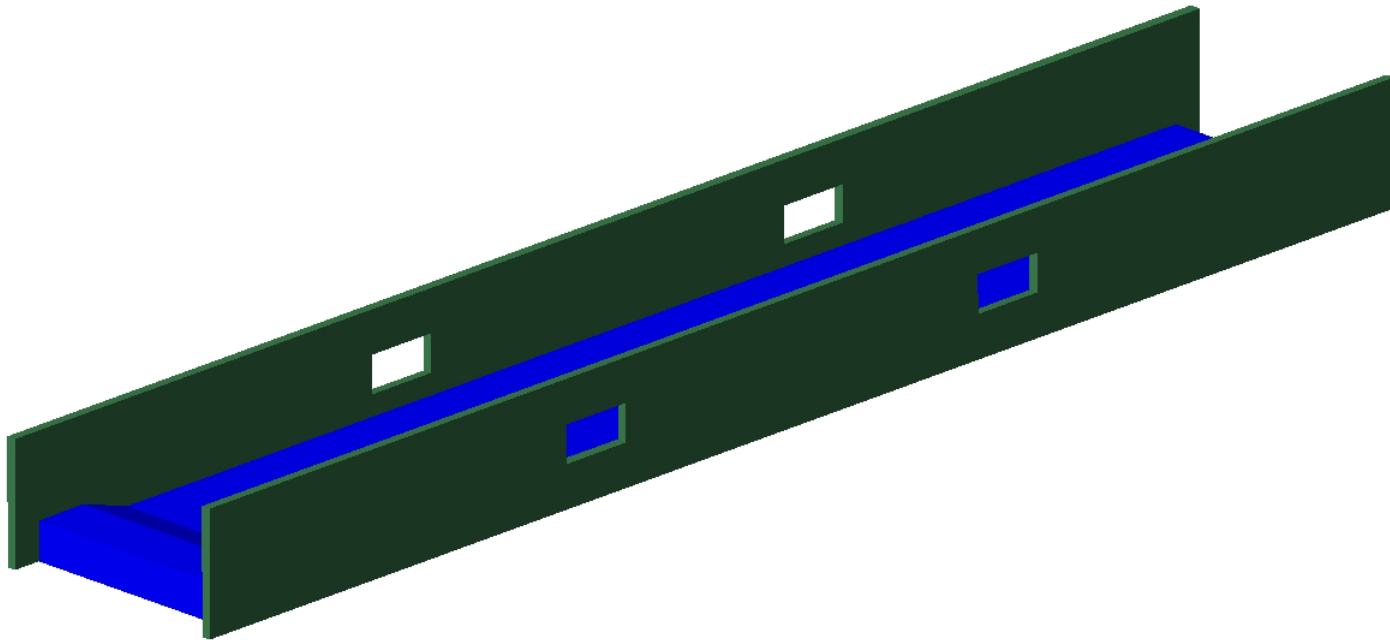

Biggest question for MR:

How will the strongback be fastened to the QBB?

The strongback will be fastened to a sub-set of the M6 holes in the OBB side rails intended for the PEEK ball end screws, as per last iTOP meeting.

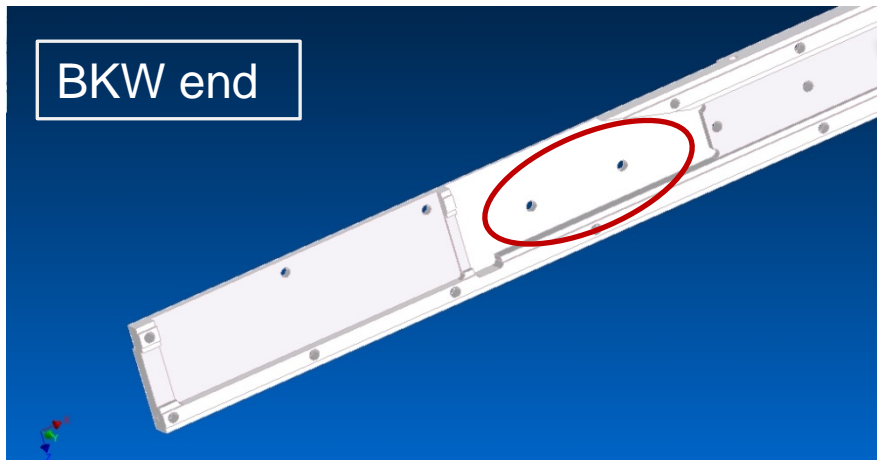
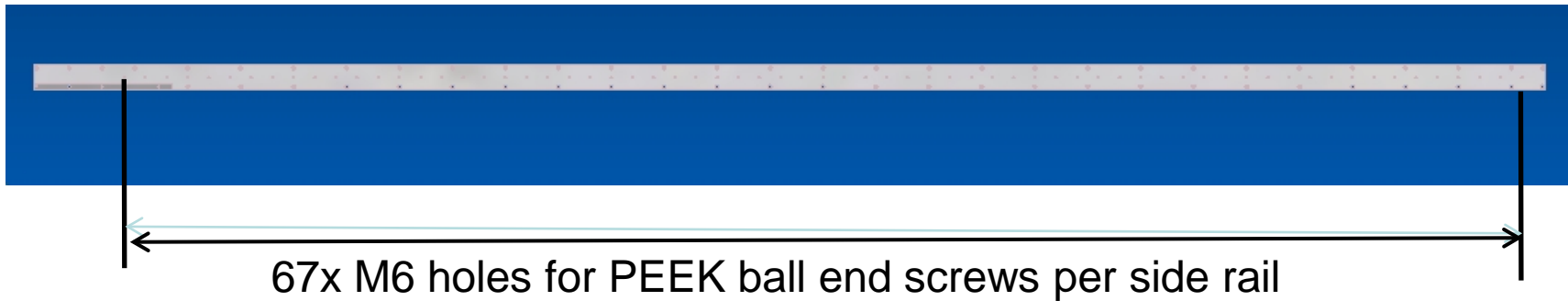

Preliminary FEA of revised strong back.

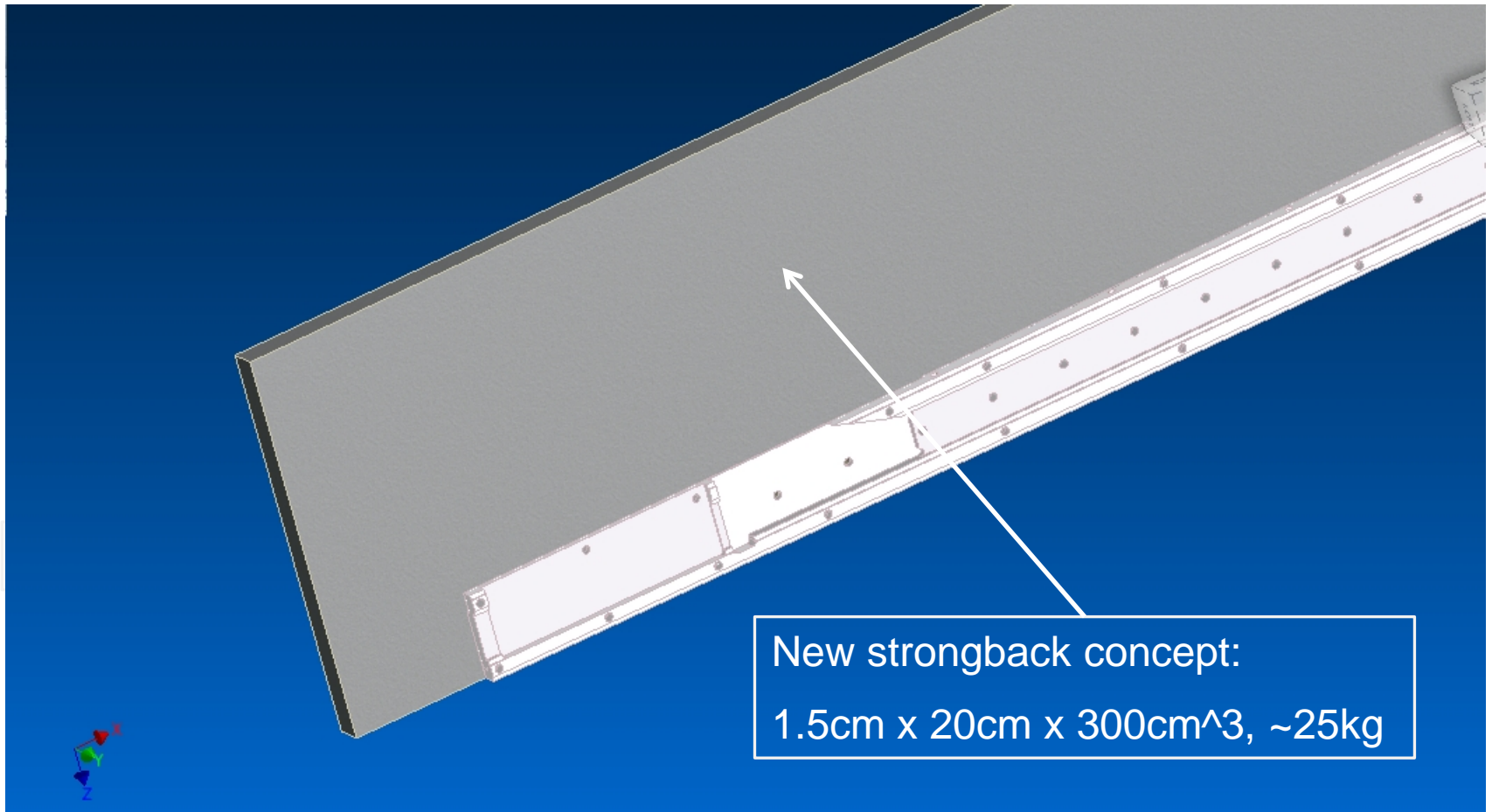

# Preliminary FEA of revised strong back.

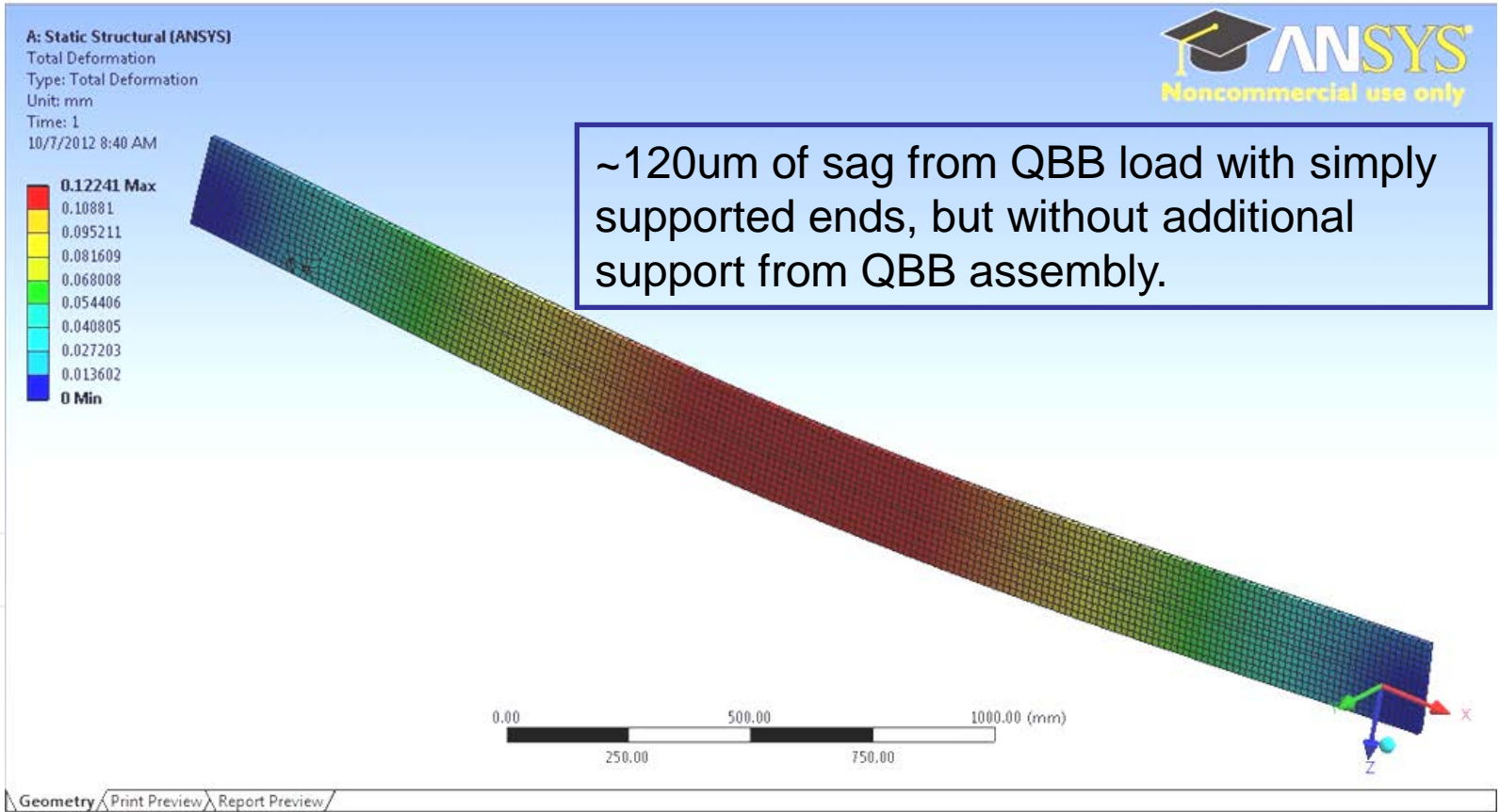

**Summary of current effort:** (all software interface issues)

- Current CAD model files are displayed using Inventor 2012.
- The Inventor CAD will not import directly into ANSYS.
- 3D.step assembly files from Kohriki-san will not import into MDT.
- IGES files from Inventor will not import assemblies into ANSYS. Hence the stand-alone strongback model.
- MR requests that Kohriki-san send just one .step file for the two side rails used in the flat panel QBB model.
- MR requests suggestions on which set of M6 side rail holes are best to incorporate as strongback support points?